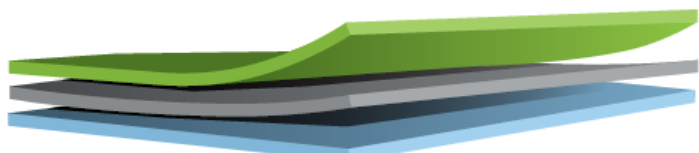

| | | |
|------------------|-------------------------------------|---|
| Codice | S4S.1001_PRT | Descrizione Busta Standup |
| Capacità | 250 g (0,8 dm³) | |
| Materiale | PET/ALU/PE | Proprietà tecniche del film Saldabilità - ASTM F88-99 Resistenza Saldatura (N/15 mm) > 32 Temperatura Saldatura (°C) 170 Pressione Saldatura (kPa) 230 Tempo Saldatura (s) 1,5 |
| Colore | | |
| Valvola | | Barriera Permeabilità Ossigeno < 0,1 ASTM D3985-95 cc/m ² /24h (23°C-0% r.h.) Permeabilità vapor d'Acqua < 0,1 ASTM F1249-90 g/m ² /24h (38°C-90% r.h.) |

COMPOSIZIONE
C/LDPE 90

| Materiale | Spessore (µm) | Grammatura (g/m²) |
|---|----------------------|-------------------------------------|
|  | 97 | 106 +/- 8 % |
| - POLYESTER | 12 | 17 |
| - ALUMINIUM | 6 | 16 |
| - POLYETHYLENE | 75 | 69 |

DIMENSIONI (mm)

| | | Tolleranza |
|--------------------------------|------------|-------------------|
| Larghezza fronte (W) | 160 | ±1,9% |
| Larghezza soffierto (G) | 95 | ±5,0% |
| Lunghezza (L) | 230 | ±1,8% |

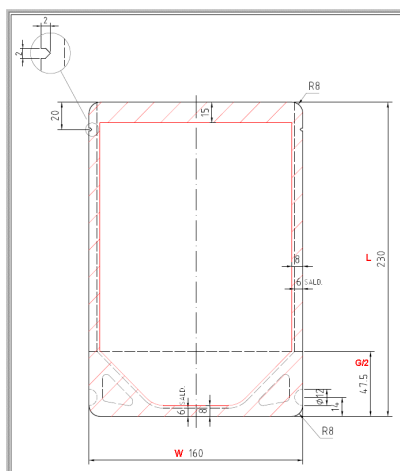



IMBALLO

| | |
|--------------------------------|----------------------------|
| Sacchetti/scatola | 2.300 |
| Scatole/pallet | 32 |
| Sacchetti/pallet | 73.600 |
| Dimensioni scatola (mm) | 555 x 245 x 265 |
| Dimensioni pallet (mm) | 1.200 x 1.000 x 150 |
| Peso scatola (kg) | 22,1 |



| | | |
|-----------------|-------------------------------|--|
| Code | S4S.1001_PRT | Description Standup Pouch |
| Capacity | 250 g (0,8 dm ³) | |
| Material | PET/ALU/PE | Film technical properties Seal Strength - ASTM F88-99 Seal strength (N/15 mm) > 32 Seal Temperature (°C) 170 Seal Pressure (kPa) 230 Seal Time (s) 1,5 |
| Colour | | |
| Valve | | Barrier Oxygen Permeability < 0,1 ASTM D3985-95 cc/m ² /24h (23°C-0% r.h.) Moisture Permeability < 0,1 ASTM F1249-90 g/m ² /24h (38°C-90% r.h.) |

STRUCTURE

| Material | Thickness (µm) | Weight (g/m ²) |
|---|----------------|----------------------------|
|  - POLYESTER | 97 | 106 +/- 8 % |
|  - ALUMINIUM | 12 | 17 |
|  - POLYETHYLENE | 6 | 16 |
| | 75 | 69 |

DIMENSIONS (mm)

| | | |
|-------------------------|------------|--------------|
| Front width (W) | 160 | ±1,9% |
| Gusset width (G) | 95 | ±5,0% |
| Length (L) | 230 | ±1,8% |

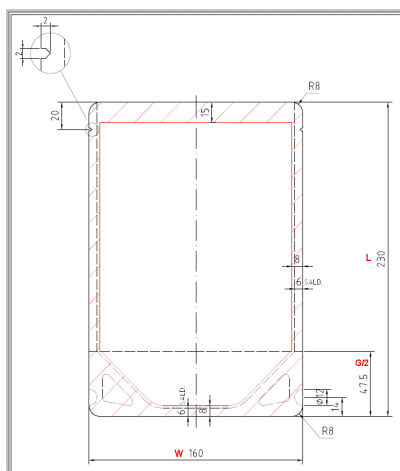
PACKAGING

| | |
|-------------------------------|----------------------------|
| Bags per carton | 2.300 |
| Cartons per pallet | 32 |
| Bags per pallet | 73.600 |
| Carton dimensions (mm) | 555 x 245 x 265 |
| Pallet dimensions (mm) | 1.200 x 1.000 x 150 |
| Weight per carton (kg) | 22,1 |



The information contained herein is supplied in good faith and does not comprise a specification or warranty of any kind, either expressed or implied, including without limitation those of merchantability and fitness for a particular purpose.